

## Description of Parts

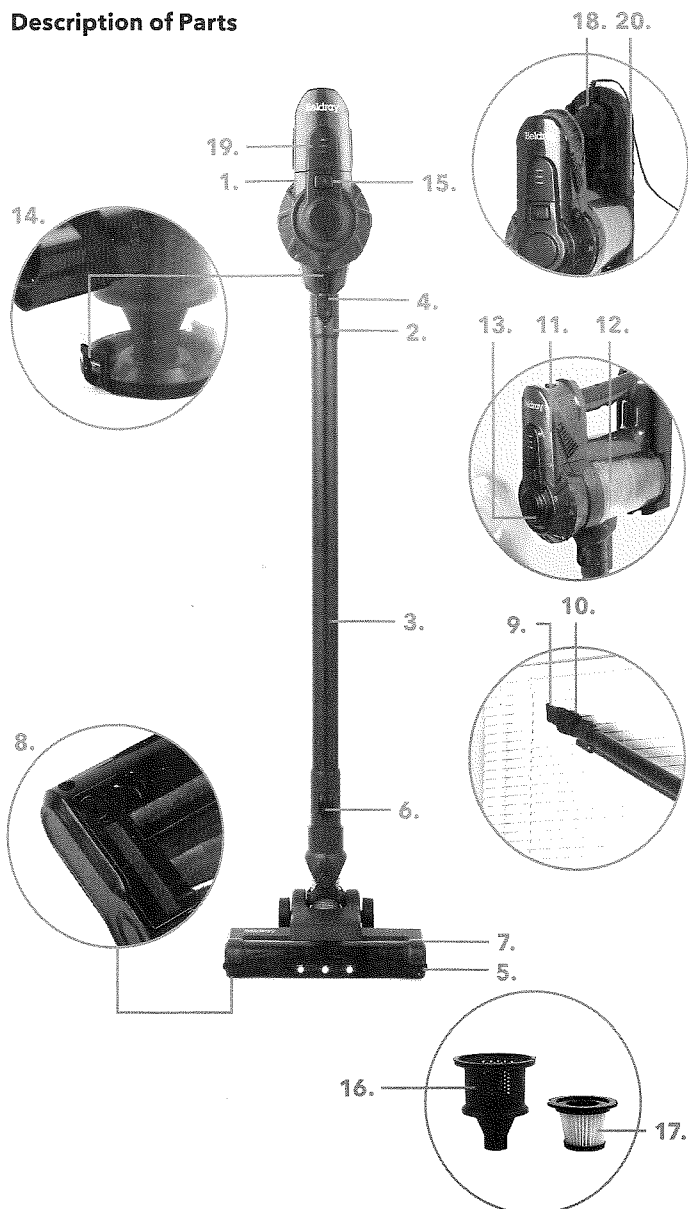

- |                                   |                                       |
|-----------------------------------|---------------------------------------|
| 1. Turbo Plus* Cordless main unit | 11. Power button                      |
| 2. Air inlet                      | 12. Dust container                    |
| 3. Extension tube                 | 13. Dust container lid                |
| 4. Extension tube release button  | 14. Dust container base release latch |
| 5. Floor brush                    | 15. Dust container release button     |
| 6. Floor brush release button     | 16. Filter cone                       |
| 7. Brush bar                      | 17. HEPA filter                       |
| 8. Brush bar release tab          | 18. Charging port                     |
| 9. 2 in 1 crevice and brush tool  | 19. LED indicator light               |
| 10. Crevice tool button           | 20. Storage hook                      |

Please read all of the instructions carefully and retain for future reference.

## Safety Instructions

When using electrical appliances, basic safety precautions should always be followed. Check that the voltage indicated on the rating plate corresponds with that of the local network before connecting the appliance to the mains power supply. Children aged from 8 years and people with reduced physical, sensory or mental capabilities or lack of experience and knowledge can use this appliance, only if they have been given supervision or instruction concerning use of the appliance in a safe way and understand the hazards involved. Children should be supervised to ensure that they do not play with the appliance. Unless they are older than 8 and supervised, children should not perform cleaning or user maintenance.

This appliance contains no user serviceable parts. If the power supply cord, plug or any part of the appliance is malfunctioning or if it has been dropped or damaged, do not use. Only a qualified electrician should carry out repairs. Improper repairs may place the user at risk of harm.

Do not remove the adaptor from the mains power supply by pulling the cord; switch off and remove the plug by hand.

Do not use the adaptor to recharge non-rechargeable batteries or any other appliance.

Do not use the appliance for anything other than its intended use.

Take care when equipping accessories with rotating parts as this could cause entrapment.

Switch off the appliance, disconnect it from the mains power supply and allow to cool fully before changing or fitting accessories and before cleaning or user maintenance.

Use of an extension cord with the appliance

is not recommended.

Only use the appliance with the power supply unit provided.

This appliance should not be operated by means of an external timer or separate remote control system.

This appliance is intended for domestic use only. It should not be used for commercial purposes.

**Caution:** The extension tube contains electrical connections. Do not use to suck up water. Do not immerse in water for cleaning. The extension tube should be checked regularly and must not be used if damaged.

## Battery Safety

The supply terminals are not to be short-circuited.

In the event of a battery pack leaking, do not allow the liquid to come in contact with the skin or eyes. If contact has been made, wash the affected area with copious amounts of water and seek medical advice.

Secondary cells and batteries need to be charged before use. After extended periods of storage, it may be necessary to charge and discharge the battery pack several times to obtain maximum performance. Do not leave a battery pack on prolonged charge when not in use.

Do not use any charger other than that specifically provided for use with the product.

Do not use any cell or battery which is not designed for use with the product.

Keep batteries out of the reach of children.

Do not crush, puncture, dismantle or otherwise the battery pack.

Do not store above 60 °C.

Avoid storage in direct sunlight.

Do not expose the battery pack to heat or fire as it may explode.

Do not subject the battery pack to mechanical shock.

To dispose of the exhausted battery pack, take it to a local recycling station. Contact the local government offices for further details. This appliance is fitted with a 22.2 V 2200 mAh Li-ion rechargeable battery.

## Do's and Don'ts

### Do:

Charge the unit fully before first use. Check that the HEPA filter is kept clear of obstruction.

Make sure that the dust container and HEPA filter are cleaned regularly.

### Don't:

Use the vacuum cleaner without the HEPA filter or dust container in position.

Use the vacuum cleaner to pick up flammable liquid, matches, cigarette ends, hot ashes or any hot, burning or smoking objects.

Use the vacuum cleaner to pick up water or any other liquid, as this poses risk of an electric shock.

### Before First Use

Before using the vacuum cleaner for the first time, clean the exterior surface with a soft, damp cloth and dry thoroughly. Do not immerse the vacuum cleaner in water or any other liquid.

### Charging the Turbo Plus<sup>+</sup> Cordless

Before first use, the vacuum cleaner must be charged for approx. 4-5 hours. Subsequent charging times will vary dependent on use.

**STEP 1:** Check that the vacuum cleaner is switched off.

**STEP 2:** Connect the mains power adaptor to the charging port on the handheld unit.

**STEP 3:** Plug the mains power adaptor into the mains power supply; the LED indicator light with flash during charging and remain illuminated once the battery is fully charged.

**Warning:** Do not use any mains power adaptor other than that supplied. Using an alternative will increase the risk of damage to the appliance or injury to the user.

If the LED lights do not illuminate when the charger is first plugged in:

**STEP 1:** Unplug the charger from the vacuum cleaner.

**STEP 2:** Turn on the vacuum cleaner for approx. 5 seconds.

**STEP 3:** Turn off the vacuum cleaner.

**STEP 4:** Reattach the charger to the vacuum cleaner; make sure it is fully inserted into the charging port.

The LED lights should now illuminate to indicate that the vacuum cleaner is charging.

### Using the Turbo Plus<sup>+</sup> Cordless

**STEP 1:** Check that the vacuum cleaner is disconnected from the mains power adaptor after unplugging it from the mains power supply.

**STEP 2:** Turn on the vacuum cleaner by pressing the power button; press once for the minimum power setting, press twice to use the maximum power setting.

**STEP 3:** To turn off the vacuum cleaner, press the power button.

The dust container and filter need to be emptied and cleaned regularly to preserve suction and prolong the life of the vacuum cleaner.

### Storage

Check that the vacuum cleaner is cool, clean and dry before storing in a cool, dry place.

Store the mains power adaptor separately, checking that it is not bent at the connections, as this could cause damage to the wires.

### Specifications

Product code: BEL01150

Battery: 22.2 V 2200 mAh Li-ion

Adaptor Input: 100-240 V ~ 50/60 Hz, 0.5 A

Adaptor Output: 26 V  $\equiv$  0.5 A, 13.0 W

Average active efficiency: 85.6 %

Efficiency at low load (10 %): 86.84 %

No load power consumption: 0.05 W

Dust tank capacity: 500 ml

The crossed out wheelie bin symbol on this item indicates that this appliance needs to be disposed of in an environmentally friendly way when it becomes of no further use or has worn out. Contact your local authority for details of where to take the item for recycling.



If this product does not reach you in an acceptable condition please contact our Customer Services Department at [www.beldray.com](http://www.beldray.com). Please have your delivery note to hand as details from it will be required. If you wish to return this product, please return it to the retailer from where it was purchased with your receipt (subject to their terms and conditions).

Go to [www.beldray.com/manuals.html](http://www.beldray.com/manuals.html) and search **BEL01150** to access the instruction manual for your product.

\*To be eligible for the extended guarantee, go to [www.beldray.com](http://www.beldray.com) and register your product within 30 days of purchase.

Rechargeable batteries are not included in the extended manufacturer's guarantee (after the first 12 months).

FULL INSTRUCTION MANUAL AT  
[www.beldray.com/manuals.html](http://www.beldray.com/manuals.html)  
PRODUCT CODE: **BEL01150**

**Beldray**<sup>est 1872</sup>  
**TURBO PLUS<sup>+</sup>**  
CORDLESS  
QUICK START GUIDE

Find us on 

[www.facebook.com/Beldray](http://www.facebook.com/Beldray)

Manufactured by:  
UP Global Sourcing UK Ltd.,  
UK. Manchester OL9 0DD.  
Germany. 51149 Köln.  
MADE IN CHINA.  
[www.beldray.com](http://www.beldray.com)

CD28012021/MD000000/V1

# **IMPORTANT**

**PLEASE READ  
AND FOLLOW**

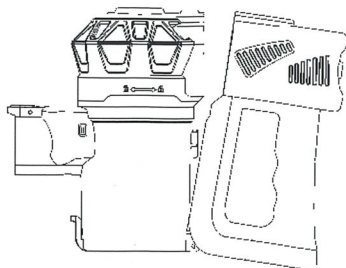

**Always fit the dust container bottom first.**

---

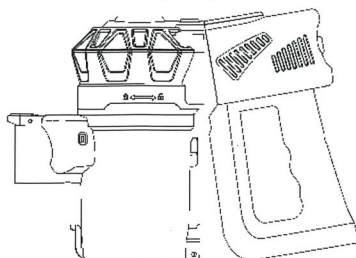

**Never fit the dust container top first.**

---

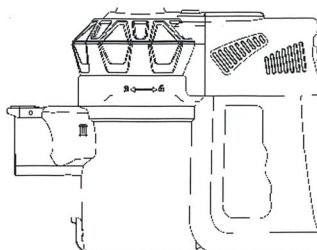

**Always push the release button  
to attach the dust container.**

**Always push the release button  
to release the dust container.**

**DO NOT IMMERSE THE DUST CONTAINER  
IN WATER OR ANY OTHER LIQUID.**



# WARNING - MUST READ

**DO NOT USE ANY CHARGING ADAPTORS WITH THE VACUUM CLEANER OTHER THAN THE ONE SUPPLIED.**

**DO NOT USE THE VACUUM CLEANER WITHOUT THE HEPA FILTER OR FILTER CONE IN POSITION; THE HEPA FILTER AND FILTER CONE MUST BE CORRECTLY FITTED BEFORE USE.**

**FAILURE TO ADHERE TO THE ABOVE COULD CAUSE DAMAGE TO THE VACUUM CLEANER.**

**FOLLOW THE INSTRUCTIONS BELOW TO CLEAN AND REFIT THE HEPA FILTER:**

**FOR OPTIMUM PERFORMANCE, WASH THE FILTER EVERY 3 WEEKS.**

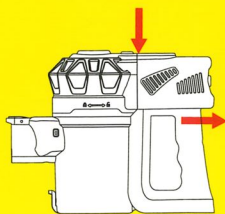

**REMOVE THE DUST CONTAINER FROM THE MAIN UNIT BY PRESSING THE DUST CONTAINER RELEASE BUTTON AND DETACHING**



**ROTATE DUST CONTAINER ANTI-CLOCKWISE TO UNLOCK POSITION**



**REMOVE HEPA FILTER FROM THE DUST CONTAINER**



**CAREFULLY WASH THE HEPA FILTER IN WARM WATER AND ALLOW TO DRY NATURALLY**



**REFIT THE HEPA FILTER INTO THE DUST CONTAINER**

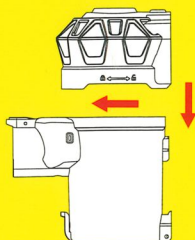

**REFIT THE DUST CONTAINER LID, ALIGNING THE ARROW WITH THE UNLOCK SYMBOL, THEN TURN CLOCKWISE TO THE LOCK POSITION AND REFIT THE DUST CONTAINER TO THE MAIN UNIT**

**IMPORTANT: DO NOT ALLOW THE DUST CONTAINER TO OVERFILL; CLEAN IT REGULARLY. FAILURE TO CLEAN THE FILTERS MAY RESULT IN POOR PERFORMANCE AND LOSS OF SUCTION POWER. DO NOT IMMERSE THE DUST CONTAINER IN WATER OR ANY OTHER LIQUID.**

# IMPORTANT: PLEASE READ

If the LED lights do not illuminate when the charger is first plugged in:

**STEP 1:** Unplug the charger from the vacuum cleaner.

**STEP 2:** Turn on the vacuum cleaner for approx. 5 seconds.

**STEP 3:** Turn off the vacuum cleaner.

**STEP 4:** Reattach the charger to the vacuum cleaner; make sure it is fully inserted into the charging port.

The LED lights should now illuminate to indicate that the vacuum cleaner is charging.